

ALL DIMENSIONS IN MILLIMETRES - DO NOT SCALE

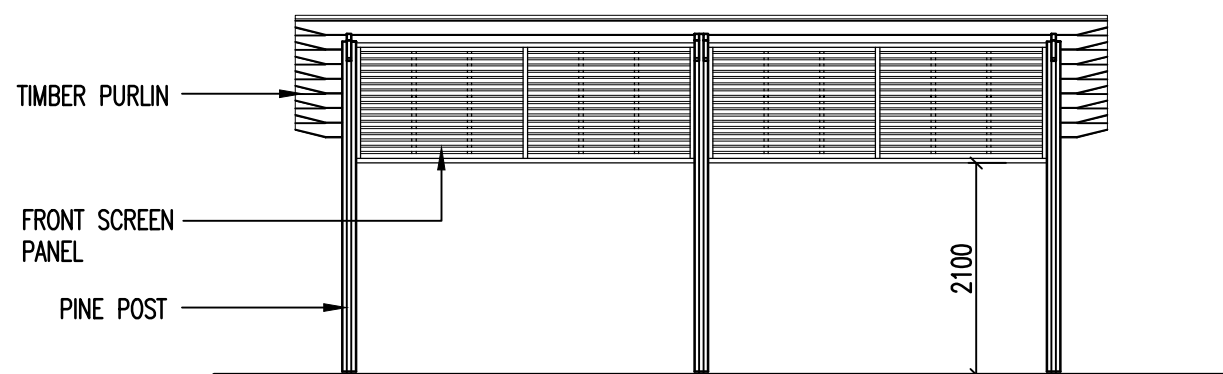

**FRONT ELEVATION**

(1:75)

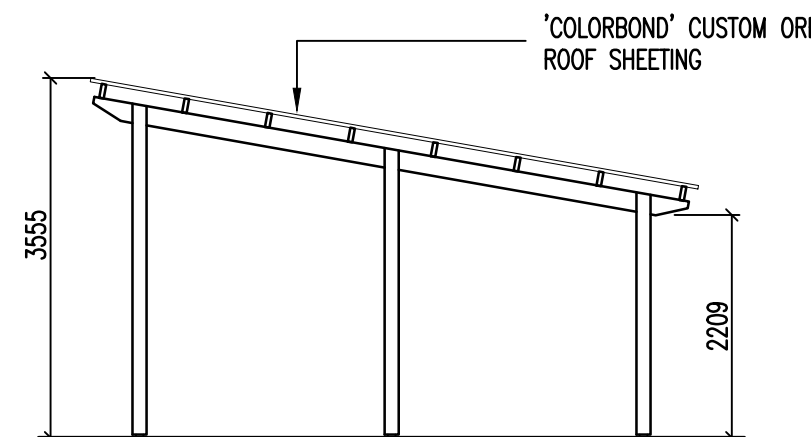

**SIDE ELEVATION**

(1:75)

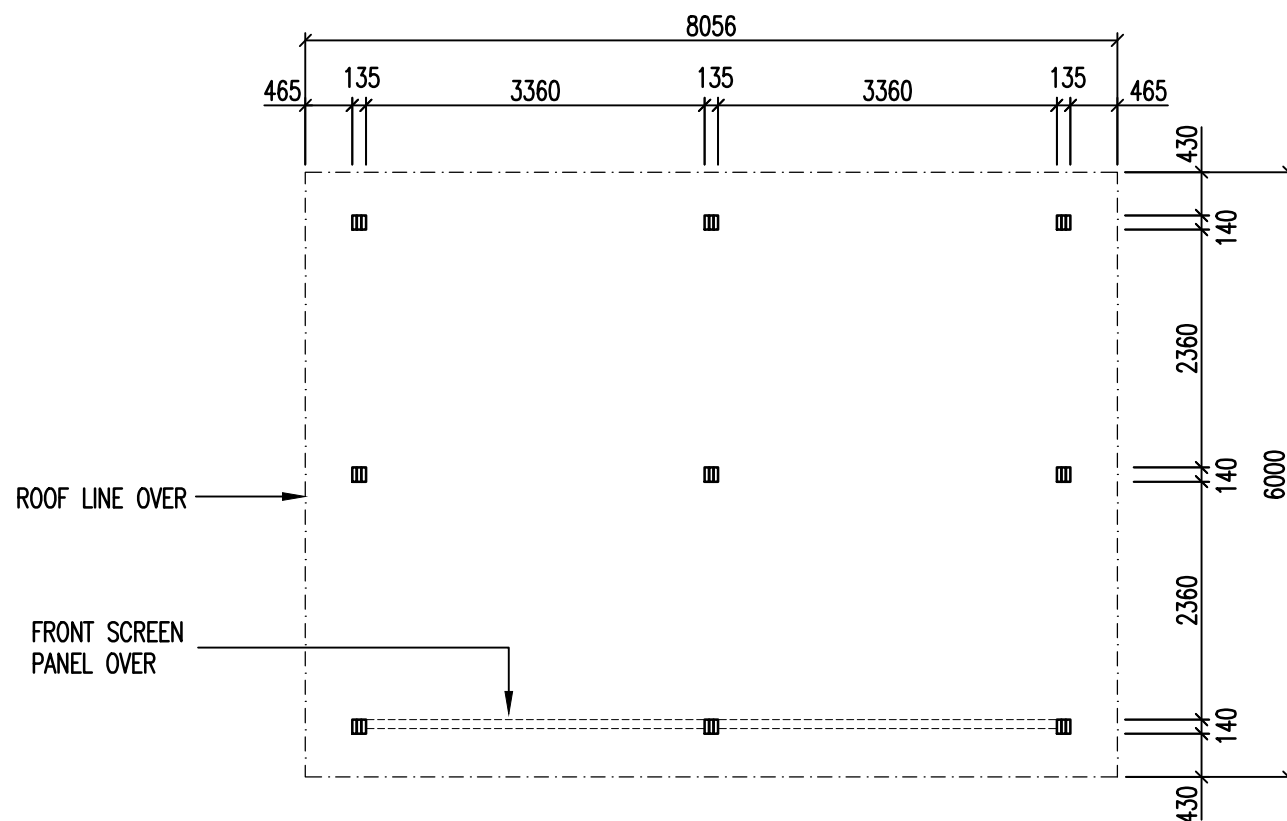

**PLAN**

(1:75)

**GENERAL NOTES:**

- G1. DURING CONSTRUCTION THE STRUCTURE SHALL BE MAINTAINED IN A STABLE CONDITION AND NO PART SHALL BE OVER STRESSED.
- G2. PRIOR TO COMMENCEMENT OF WORKS THE BUILDER SHALL SATISFY THEMSELVES OF THE CORRECT LOCATIONS OF ALL EXISTING SERVICES WHETHER INDICATED OR NOT ON THE PLANS.
- G3. LOCATING OF THE STRUCTURE, INCLUDING CO-ORDINATES IF APPLICABLE, IS THE RESPONSIBILITY OF THE CLIENT AND/OR THE CLIENT'S SITE REPRESENTATIVE.
- G4. STRUCTURE HAS BEEN DESIGNED IN ACCORDANCE TO THE FOLLOWING AUSTRALIAN STANDARDS:  
- AS1170.1, AS1170.2, AS1720.1, AS3600 AND AS4100, AS1664.
- G5. STRUCTURE IS SUITABLE FOR N3 AREAS AND HAS BEEN DESIGNED WITH AN AVERAGE RECURRENCE INTERVAL OF 100 YEARS.
- G6. SITE COVERAGE IS 48.00m<sup>2</sup> (ROOF AREA).
- G7. THE FOOTING HAS BEEN DESIGNED ASSUMING:  
- SITE CLASS S OR M  
- ALLOWABLE SOIL BEARING CAPACITY OF 100kPa  
- SOIL ADHESION OF 10kPa  
(TO BE VERIFIED ON SITE).
- G8. FOR SLABS ON GROUND, ALL TOPSOIL AND UPPER STRATA CONTAINING SOFT OR ORGANIC MATTER ARE TO BE REMOVED AND REPLACED WITH SELECT COMPACTED FILL.
- G9. ALL FILL TO BE CLEAN, PLACED IN LAYERS NOT EXCEEDING 200mm AND COMPACTED TO 95% STANDARD COMPACTION.
- G10. EARTHWORKS SHALL BE CARRIED OUT IN ACCORDANCE WITH CRITERIA AND PROCEDURES SET OUT IN AS3798 GUIDELINES ON EARTHWORKS FOR COMMERCIAL AND RESIDENTIAL DEVELOPMENTS.

REVISION	DATE:	DRAWN BY:	CHECKED BY:	DATE:	CLIENT NAME	PROJECT	DRAWING TITLE	PROJECT No.	PAGE
6	-	-			LANDMARK PRODUCTS LTD	-	BA - PLAN AND ELEVATIONS	-	A3
5	-	-						DATE:	DRAWN
4	-	-						04.06.12	BMM
3	-	-						DRAWING No.	SCALE
2	-	-						K3054P*P*IG	NTD
1	-	-						SHEET No.	REV.
								101	0

© LANDMARK PRODUCTS LIMITED  
THIS DOCUMENT IS AND SHALL REMAIN THE PROPERTY OF LANDMARK PRODUCTS LIMITED. UNAUTHORISED USE OF THIS DOCUMENT IN ANY FORM IS PROHIBITED.



Landmark Products Limited. PH: 1300 768 230  
A.B.N. 99 112 000 843 FAX: 1300 768 260  
55-57 Kabi Circuit, Deception Bay  
P.O. Box 603, Deception Bay www.landmarkpro.com.au  
Queensland 4508 landmark@landmarkpro.com.au