

Finishes: Powder coated (painted) or mill finish - see works order

NOTE: For fettling/grinding/finishing refer to - Fettling Procedure (Grinding steps) sheet.



Quality
ISO 9001
SAI GLOBAL

Drill holes to 7/32"
26 places

Inside edge

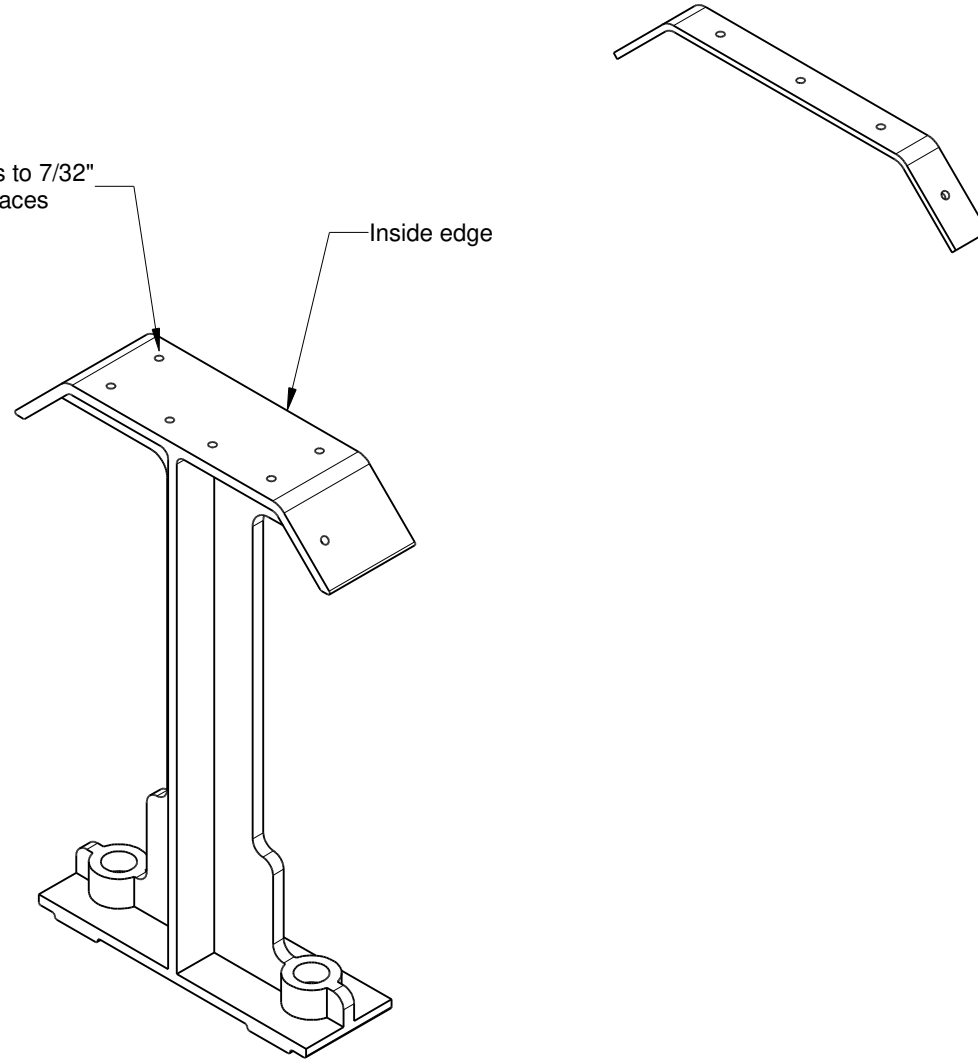

SIGNIFICANT CHARACTERISTICS TO BE INSPECTED

Surface finishes/
imperfections

Hole sizes &
positioning

To be mill or
powder coat
product

**Tick if
correct:
Notes or
faults:**

© copyright

CONFIDENTIAL

REVISION	#	DESCRIPTION	BY	DATE	DRAWN	DRAWN DATE	CHECKED	CHECKED DATE	SCALE	A4
	1	ORIGINAL DRAWING	RBC	24.1.14	R.CRIGTON	24.1.14			N/A	
	2									
	3									
	4									
	5									
							FORESHORE BENCH FETTLING PROCEDURE			
							FFSA001016		REV. 1	SHEET 3 OF 3