



AQUA-HUB INSTALLATION INSTRUCTIONS



Supplying water
to Australian
communities
since 1873



www.furphyfoundry.com.au

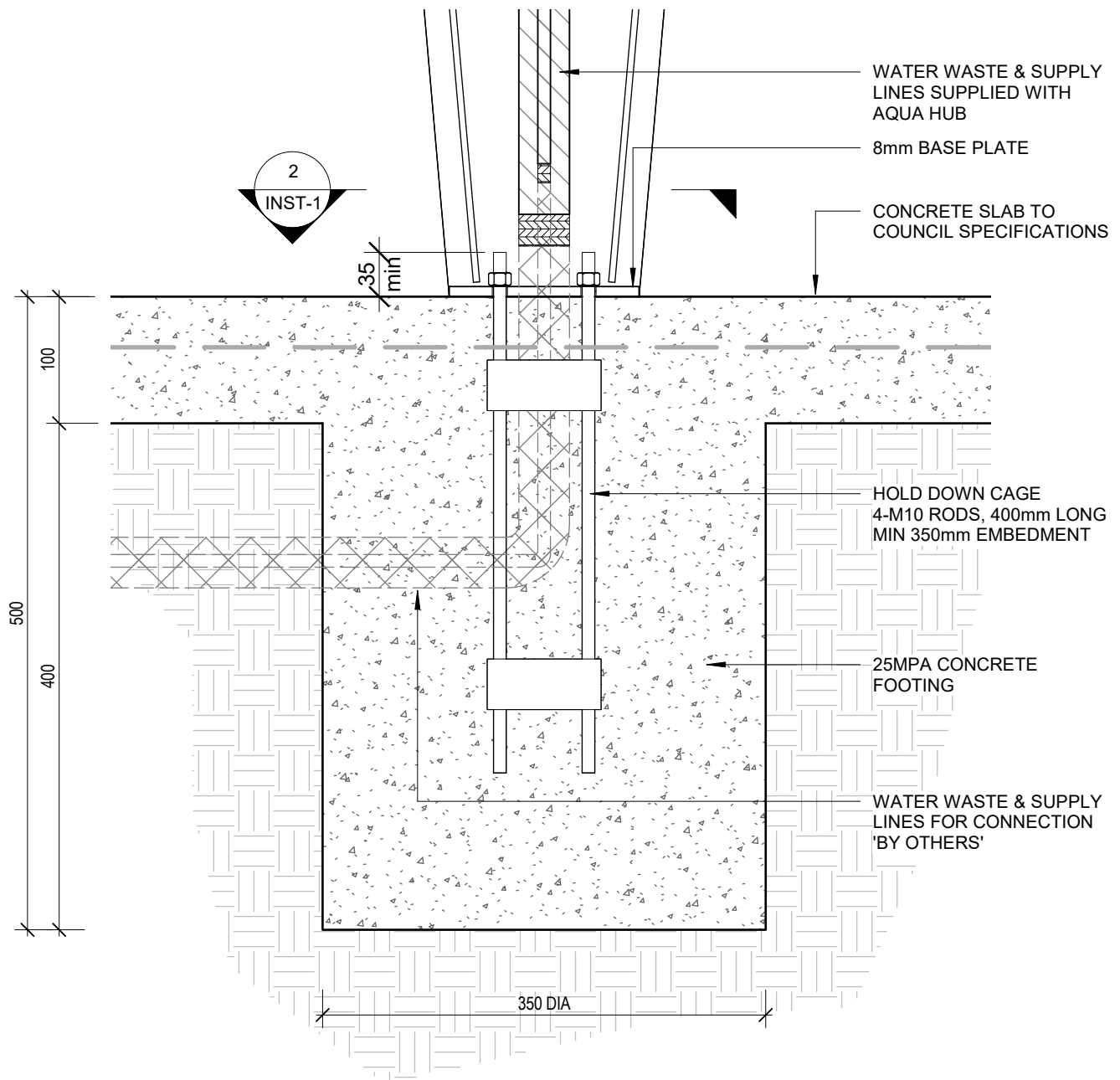

1 TYPICAL SECTION

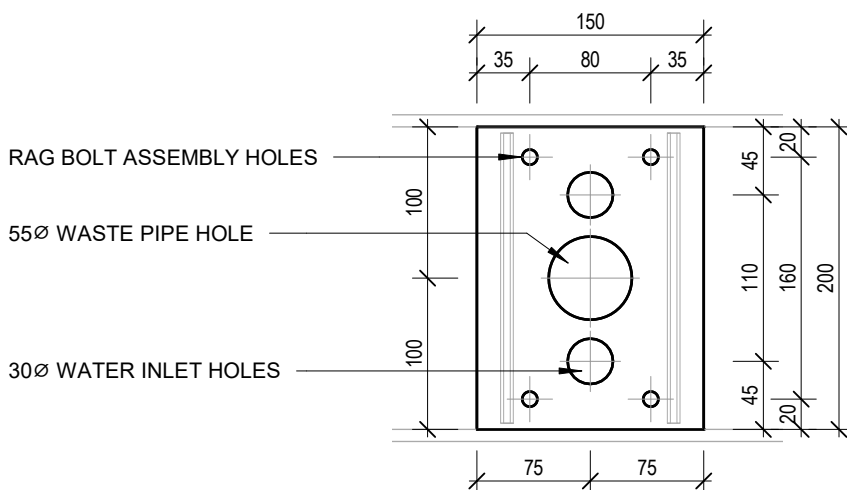

2 BASE PLATE SETOUT



1. Dig and prepare foundation hole as per detail (full view on page 2)

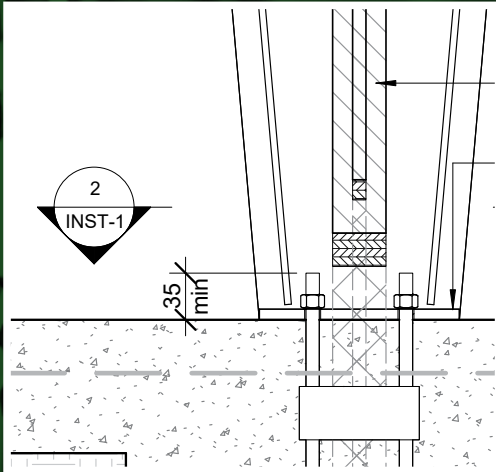

2. Ensure supplied Rag Bolt Assembly is located centrally in foundation hole and set top of all threads a minimum of 35mm above proposed finish height

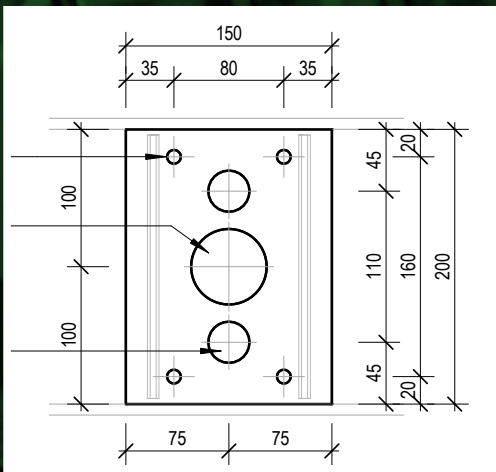

3. Ensure Service Lines i.e. waste and inlet water lines are located as per laser cut base plate entry holes (refer base plate setout detail)



4. Once Rag Bolt Assembly and Service Lines are correctly installed - pour concrete, filling to desired height of bottom of Aqua-Hub Base Plate

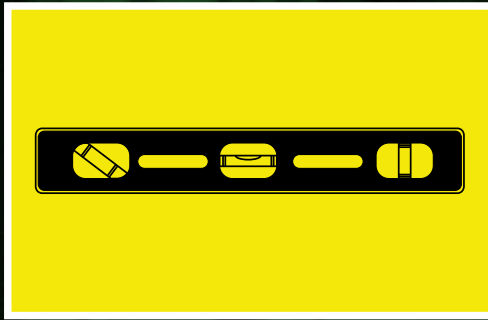

5. Ensure concrete levels are correct and finished prior to concrete setting



6. Remove Stainless Steel Inspection Panel from Aqua-Hub Drinking Fountain and remove in-line trap

7. Trim and prepare previously installed Service Lines to appropriate height

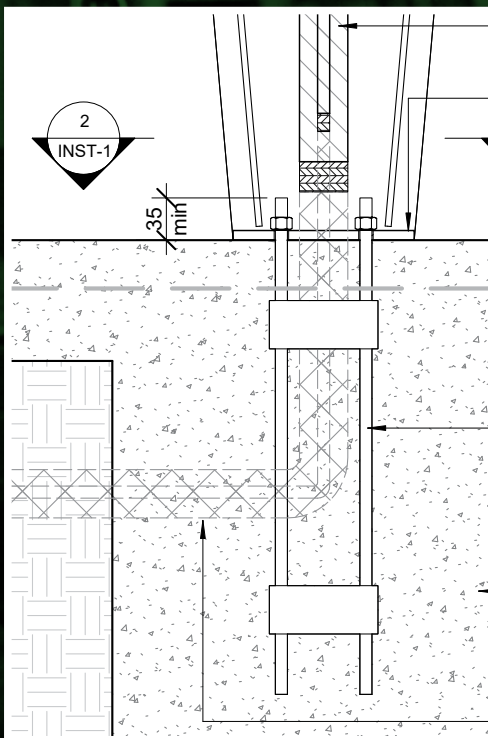

8. Install Aqua-Hub onto set concrete pad/slab to ensure alignment of Rag Bolt Assembly and Service Lines and tighten down with supplied nuts



9. Secure 12mm Plumbing Easy Hose to previously prepared inlet service line



10. Re-instate in-line trap to both Aqua-Hub unit and waste-line

11. Test Aqua-Hub unit for leaks at Service Lines (inlet and waste)

12. Re-instate Stainless Steel Inspection Panel





Our range of Furphy Aqua-Hub Drinking Fountains have been created to provide safe, clean and cost effective public drinking facilities that are ideal for public environments.

Hand-made in Australia at the Australian owned Furphy Foundry in Shepparton, each Furphy Aqua-Hub Drinking Fountain has been manufactured under strict quality guidelines based on a commitment developed since 1864.

Furphy Foundry Drinking Fountains have been tried and tested throughout Australia in a range of applications with exceptional results. There are 4x standard and 4x DDA compliant designs available to choose from in the Furphy Aqua-Hub range - WaterMark certified (WMK26602, WMTS105:2016) to ensure all plumbing componentry comply with state and territory plumbing codes

Each unique design has its own set of features, enabling the Furphy Aqua-Hub to be matched with other assets and integrated into public environments.



Call 1300 768 230
or visit our website
furphyfoundry.com.au
for more info

